

717 SERIES

FLAMMABLE MATERIAL LOCATIONS

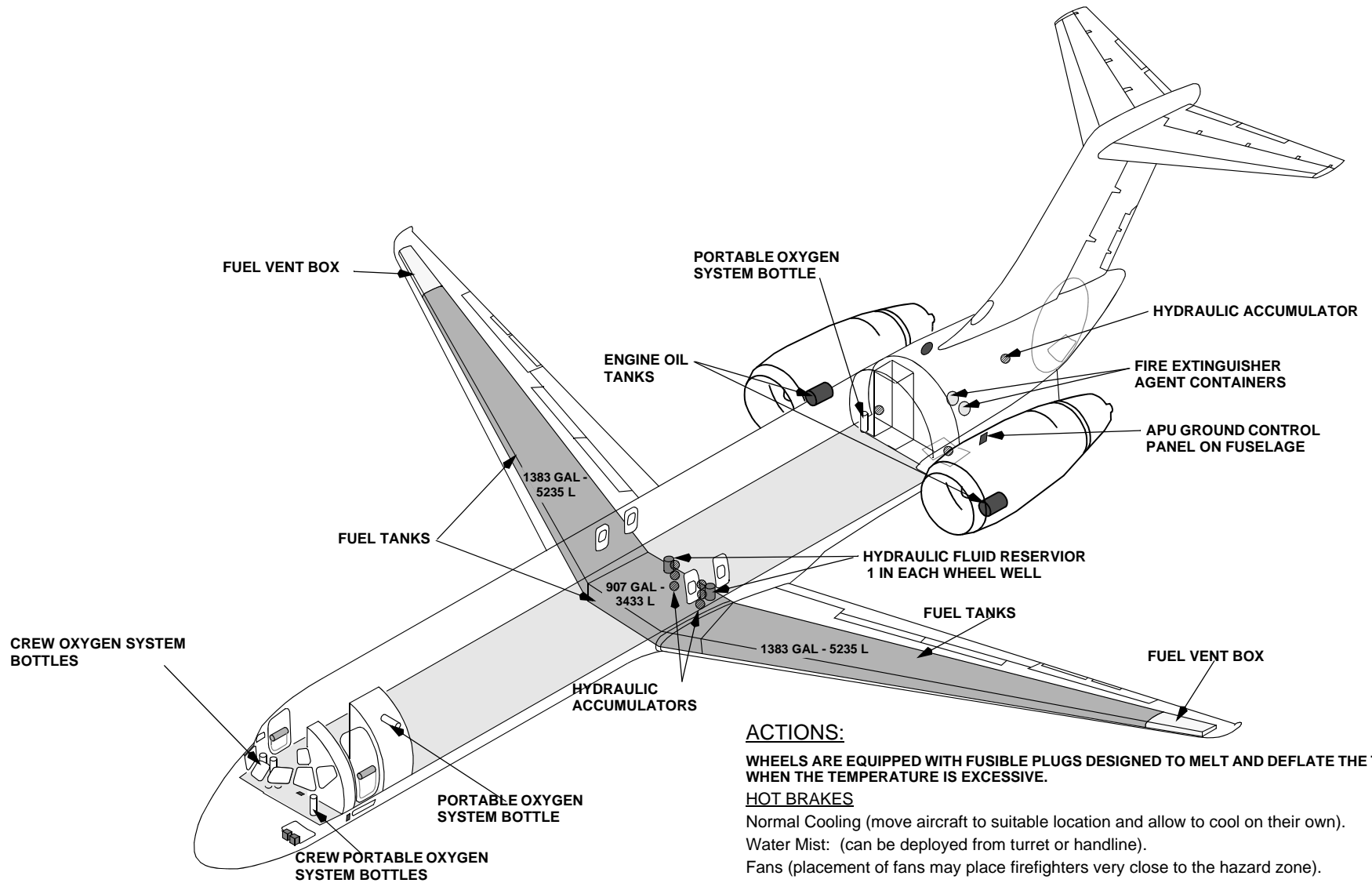

ACTIONS:

WHEELS ARE EQUIPPED WITH FUSIBLE PLUGS DESIGNED TO MELT AND DEFLATE THE TIRE WHEN THE TEMPERATURE IS EXCESSIVE.

HOT BRAKES

Normal Cooling (move aircraft to suitable location and allow to cool on their own).

Water Mist: (can be deployed from turret or handline).

Fans (placement of fans may place firefighters very close to the hazard zone).

WHEEL FIRE

Large amounts of water initially with turrets.

Transition to handline application to continue and maintain a cooling effect.

WARNING: APPROACH LANDING GEAR TRUCK FROM FORWARD OR AFT WHEN FIGHTING A WHEELFIRE, AS WHEELS AND TIRES MAY EXPLODE.

717 SERIES

EMERGENCY RESCUE ACCESS-1

1 PASSENGER AND SERVICE DOORS

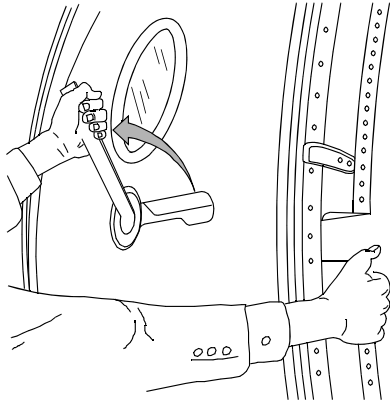

TO OPEN DOOR:

1. PULL HANDLE FROM RECESS.
2. ROTATE HANDLE AFT.
3. PULL DOOR OPEN.

2 OVERWING EMERGENCY EXITS



TO OPEN DOOR:

1. PUSH HANDLE RELEASE.
2. PULL THE HANDLE AND, AT THE SAME TIME, PUSH IN TOP OF DOOR FORCIBLY.

3 TAIL CONE JETTISON LATCH

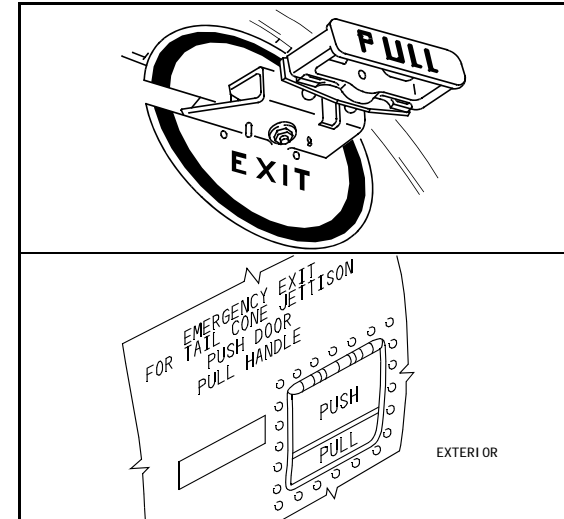

4 CHOP OUT AREAS

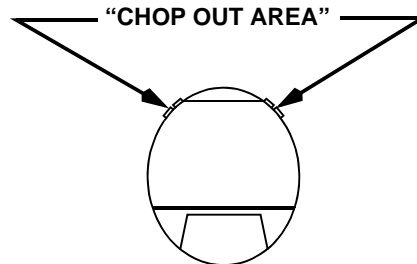

NOTE: "CHOP OUT" AREAS REQUIRE METAL CUTTING PORTABLE POWER EQUIPMENT. BECAUSE OF TYPE OF STRUCTURE AND POSSIBLE INJURY TO PERSONNEL WITHIN, IT IS RECOMMENDED THAT MAJOR EFFORT TO GAIN ACCESS BE DIRECTED TO HATCHES AND DOORS. URGENCY OF SITUATION WILL DICTATE NECESSITY FOR "CHOP OUT."

717 SERIES

EMERGENCY RESCUE ACCESS-2

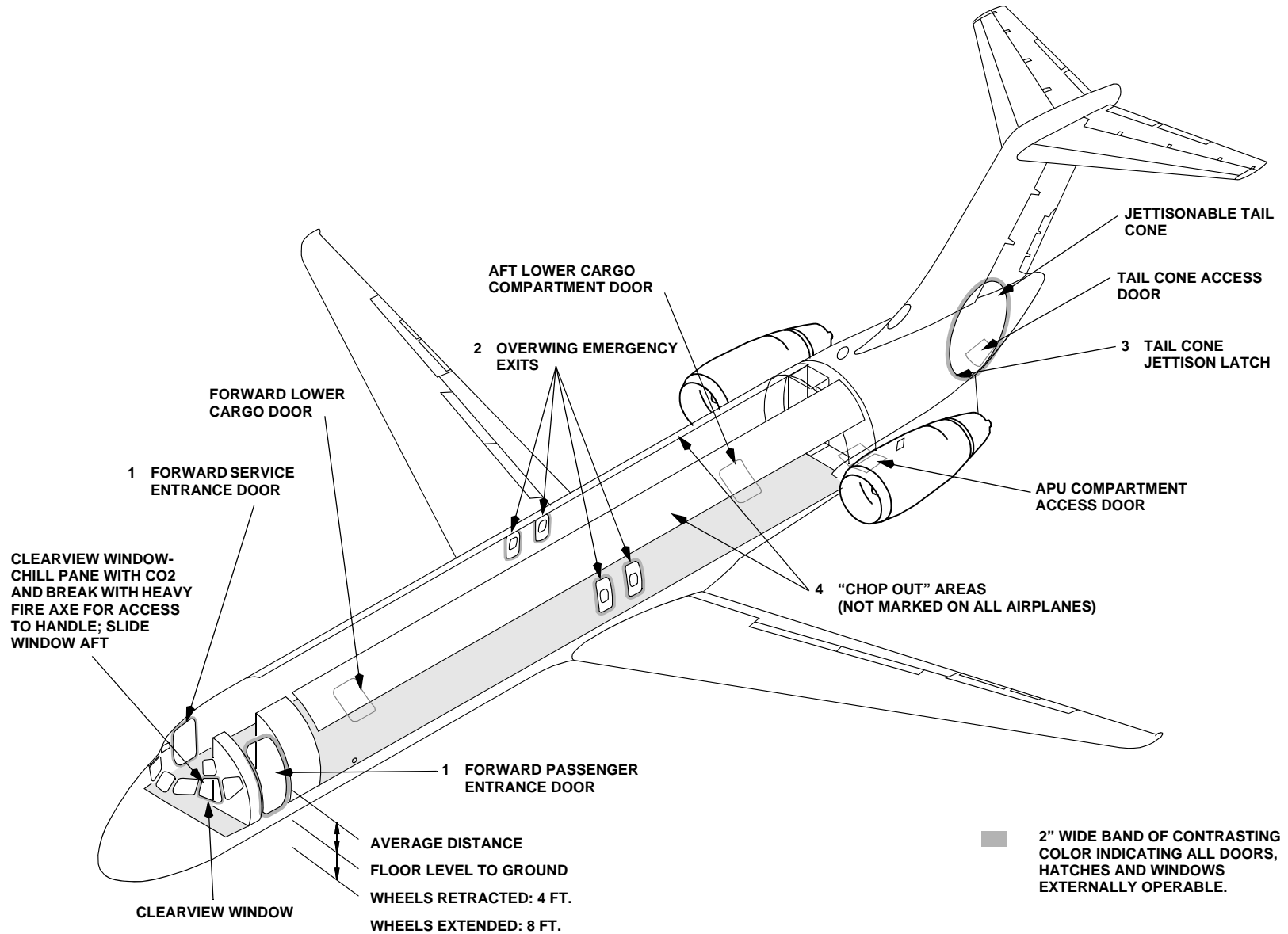

717 SERIES

BATTERY LOCATIONS

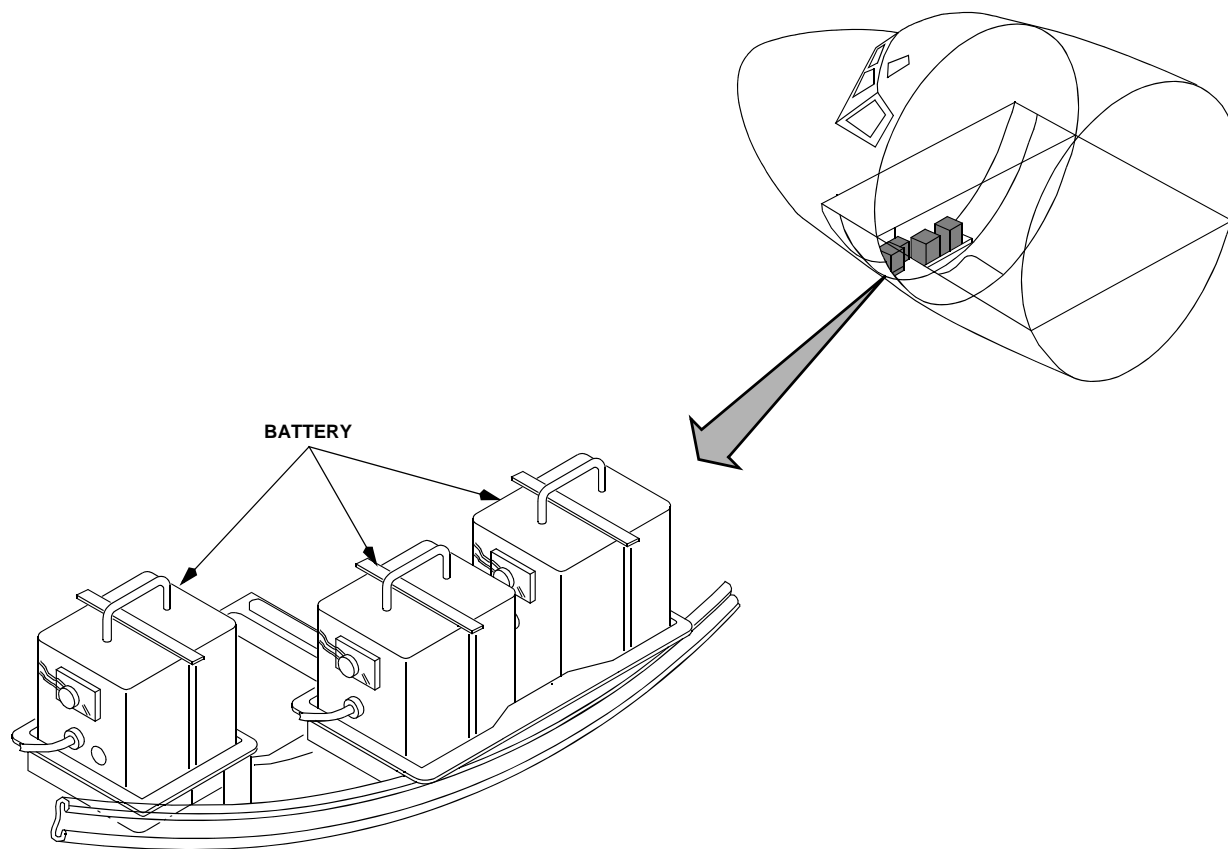

717 SERIES

FLIGHT DECK CONTROL SWITCH LOCATIONS

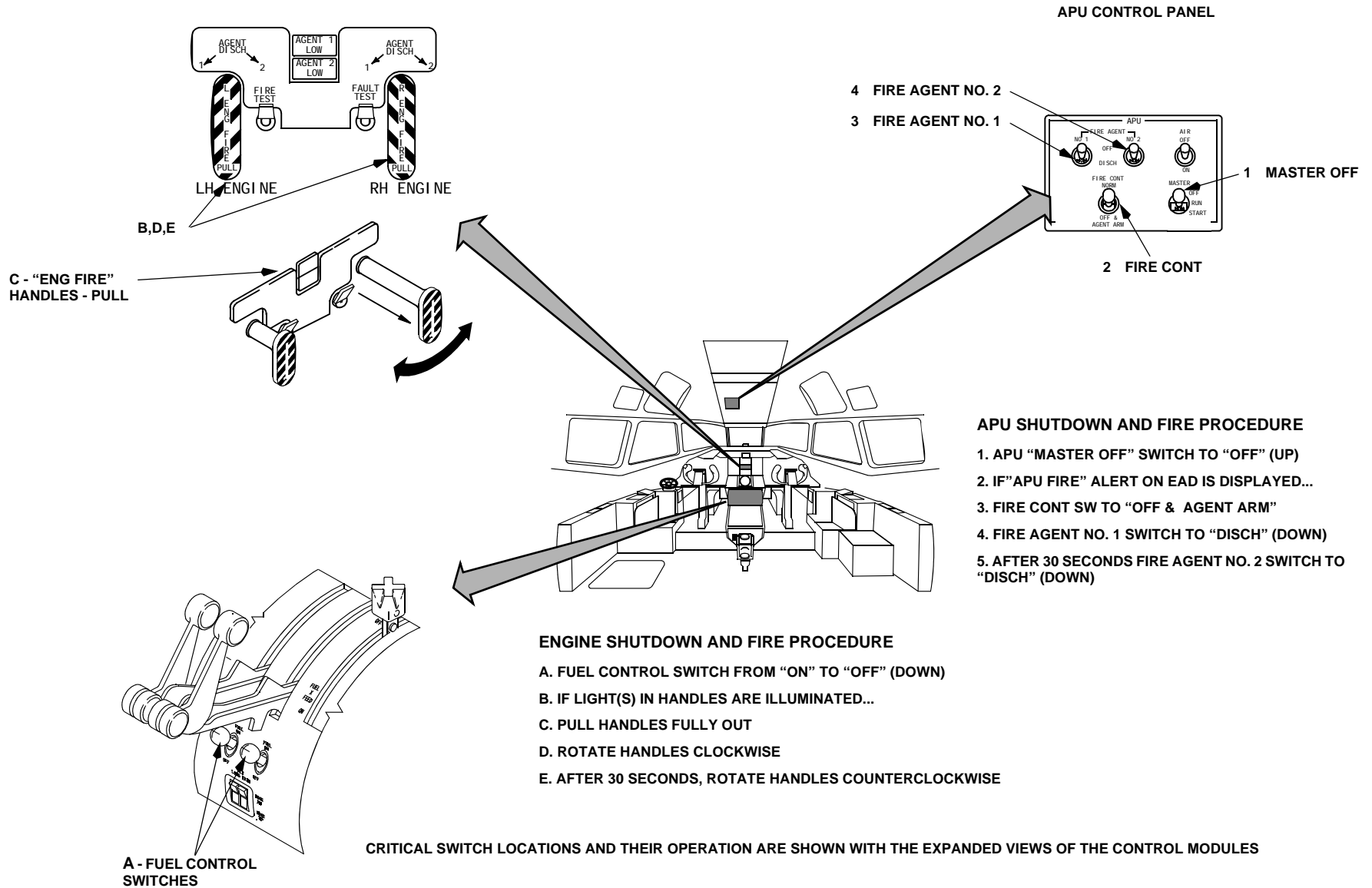

717 SERIES

EXTERNAL APU FIRE CONTROLS

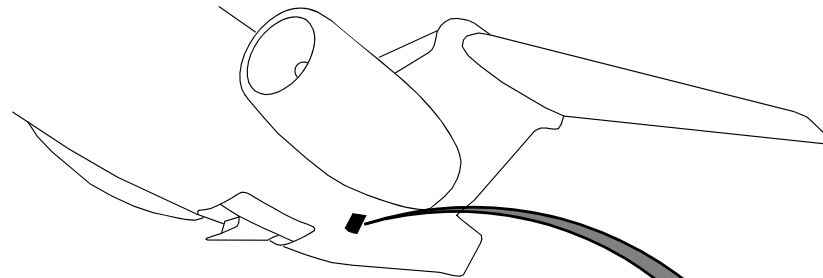

2 FIRE LIGHT

APU SHUTDOWN AND FIRE PROCEDURE

1. "APU SHUT OFF" SWITCH TO "SHUT OFF" (UP)
2. IF "FIRE" LIGHT IS ILLUMINATED...
3. FIRE AGENT 1 SWITCH TO "DISCHARGE" (UP)
4. AFTER 30 SECONDS, FIRE AGENT NO 2 SWITCH TO "DISCHARGE" (UP)

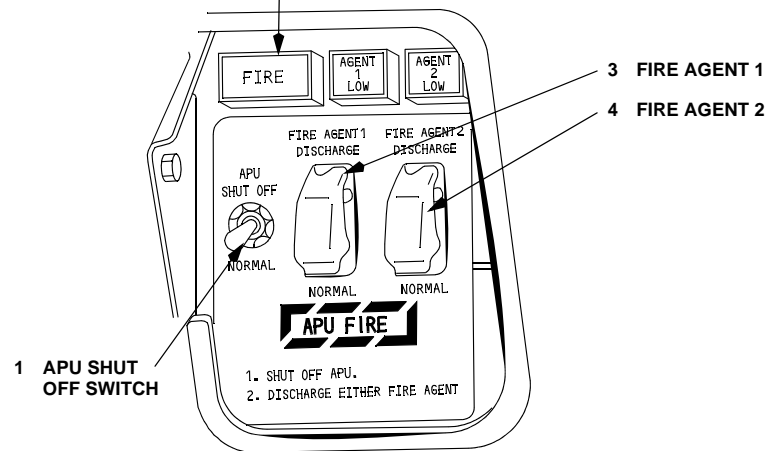

717 SERIES

COMPOSITE MATERIALS LOCATIONS

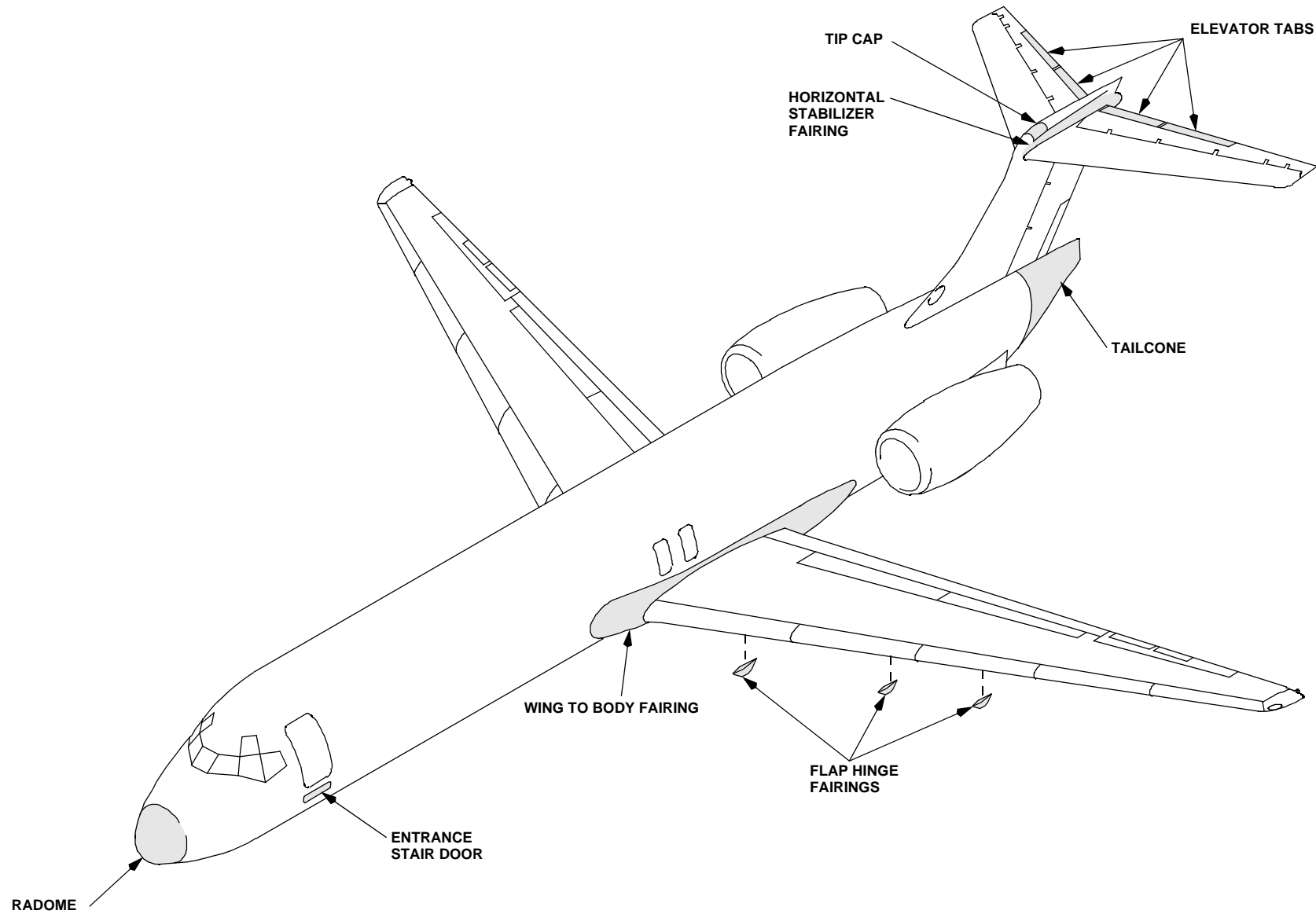

717 SERIES

Intentionally Blank